

Bidones con Tapón/Grifo

Jerry cans with Cap/Tap

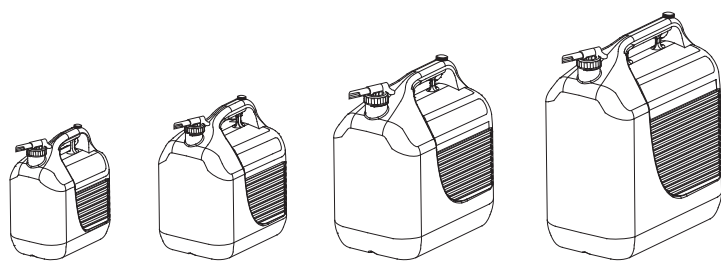

| | | | | |
|---|----------------|----------------|-----------------|-----------------|
| Código Code | 601361 | 602368 | 603365 | 604362 |
| Capacidad Capacity | 5 l. | 10 l. | 20 l. | 30 l. |
| Medidas Sizes | 230x145x257 mm | 265x200x307 mm | 345x234x377 mm | 400x237x464 mm |
| Material | HDPE | HDPE | HDPE | HDPE |
| Embalaje Packing | 6 unid. | 6 unid. | 5 unid. | 5 unid. |
| Medidas Embalaje Packing Sizes | 780x290x230 mm | 780x396x307 mm | 1175x377x345 mm | 1180x400x464 mm |



 **APTO PARA USO ALIMENTARIO**
Registro sanitario / Health registration
n° 3900923/V

NO USAR HIDROCARBUROS
DO NOT USE HYDROCARBON

Tapón grifo

Cap/Tap

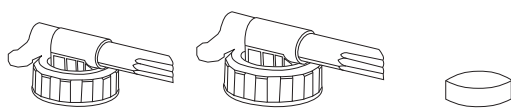

| | | | |
|------------------------------|---------------|---------------|---------------|
| Código Code | 609008 | 610004 | 617003 |
| Capacidad Capacity | 5 l. y 10 l. | 20 l. y 30 l. | |

